

OVERALL HEIGHT = 106.5"
 OVERALL WIDTH = 98"
 DIMENSIONS ARE NOMINAL

3M OPTICOM

(2) WHELEN 900 RED SUPER LED WITH CLEAR LENSES

(2) WHELEN 900 BLUE SUPER LED WITH CLEAR LENSES

WHELEN 600 AMBER LED TURN ARROWS

WHELEN 900 90BA5FCR BLUE OVER AMBER SUPER LED WITH CLEAR LENS

WHELEN 900 RED OVER AMBER SUPER LED WITH CLEAR LENS

VELVAC 2020 HEATED/REMOTE MIRRORS -BLACK FINISH-

FLASHING HEADLIGHTS W/ DAYTIME RUNNING LIGHTS

WHELEN 4" WHITE LED RUNNING BOARD LIGHT

BUELL 10"/12" AIR HORNS

FEDERAL BP200EF 200 WATT SIREN SPEAKER CONNECTED TO EQ2B CONTROL

WHELEN 500 SUPER LED GRILLE LIGHTS--UPPER WITH CLEAR LENSES RED=PASSENGER SIDE BLUE=DRIVERS SIDE

WHELEN 500 SUPER LED GRILLE LIGHTS--LOWER WITH CLEAR LENSES BOTH TO BE AMBER

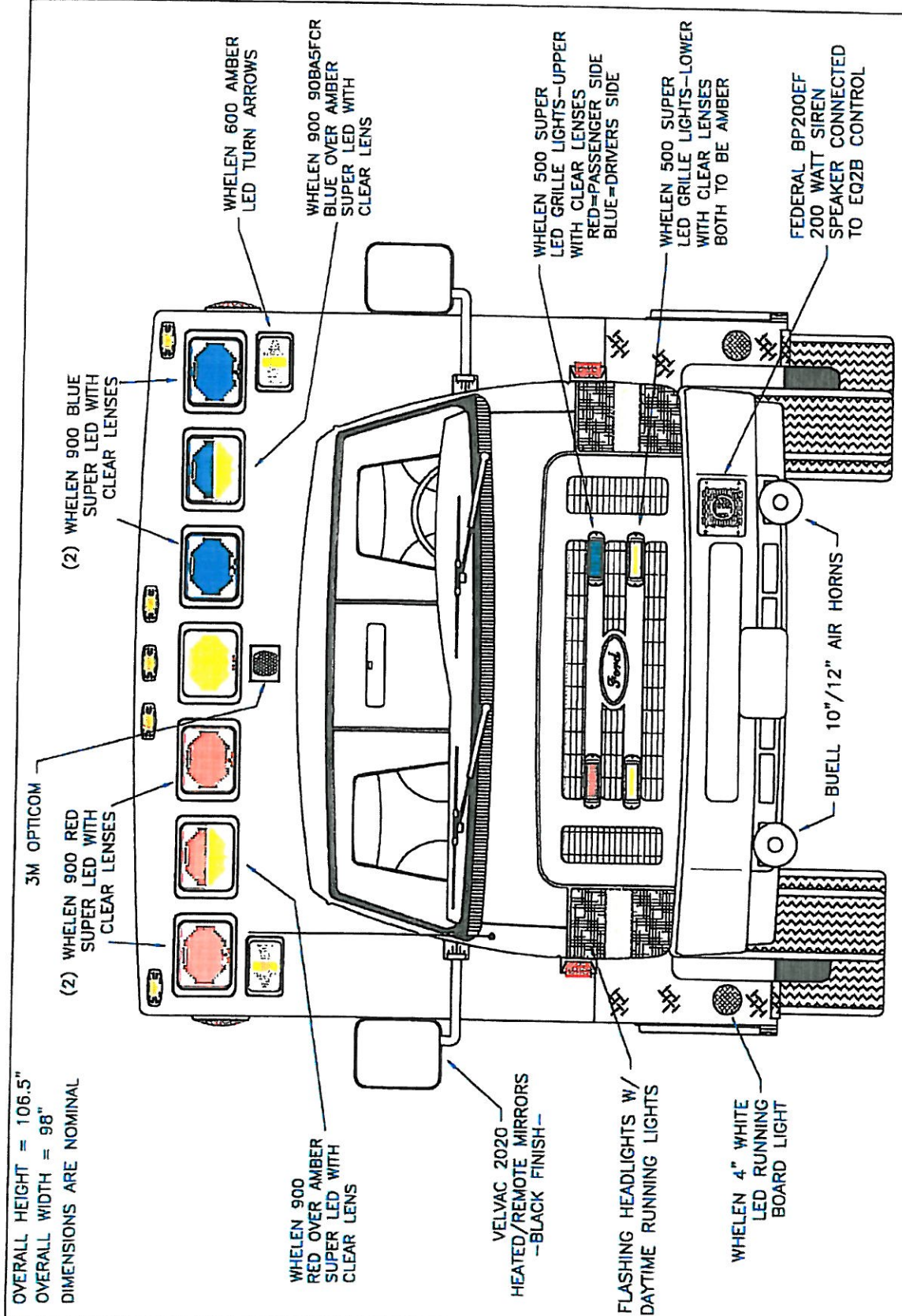

LITTLETON, COLORADO

2009 FRONT EXTERIOR VIEW
 FORD E-450 CHASSIS

DATE: 02 FEB 09
 DWG: GLF
 REV: B

1:17

DRAWING NO.

LITTLETON-10

OVERALL HEIGHT = 106.5"
 OVERALL WIDTH = 98"
 FLOOR HEIGHT = 33"
 DIMENSIONS ARE NOMINAL

(2) WHELEN 24 DIODE 900 SERIES
 WHITE SUPER LED LOAD LIGHTS

WHELEN 700 AMBER
 SUPER LED WITH CLEAR LENS

WHELEN 900 90BA5FCR
 AMBER OVER BLUE
 SUPER LED WITH
 CLEAR LENS

CAST PRODUCTS
 DOOR GRABBERS

WHELEN RED LED STRIP
 LIGHT CENTER BRAKE

WHELEN 900 AMBER
 SUPER LED WITH
 CLEAR LENS

WHELEN 900 AMBER
 SUPER LED WITH
 CLEAR LENS

WHELEN 900 RED
 SUPER LED WITH
 CLEAR LENS

WHELEN 900 BLUE
 SUPER LED WITH
 CLEAR LENS

CPI RECESSED
 LICENSE PLATE
 HOLDER WITH
 LED LIGHT

ONE (1) EACH SIDE IN
 WHELEN CAST-4V HOUSINGS:
 600 LED BRAKE/TAIL,
 600 LED TURN,
 600 HALOGEN BACK-UP,
 600 AMBER SUPER LED WARNING

HIDDEN UNLOCK SWITCH
 BEHIND LICENSE PLATE

DOCK BUMPERS

INDEPENDENT BUMPER WITH
 FLIP-UP CENTER STEP AND
 TOW HOOKS

MUD FLAPS

ONSPOT TIRE CHAINS

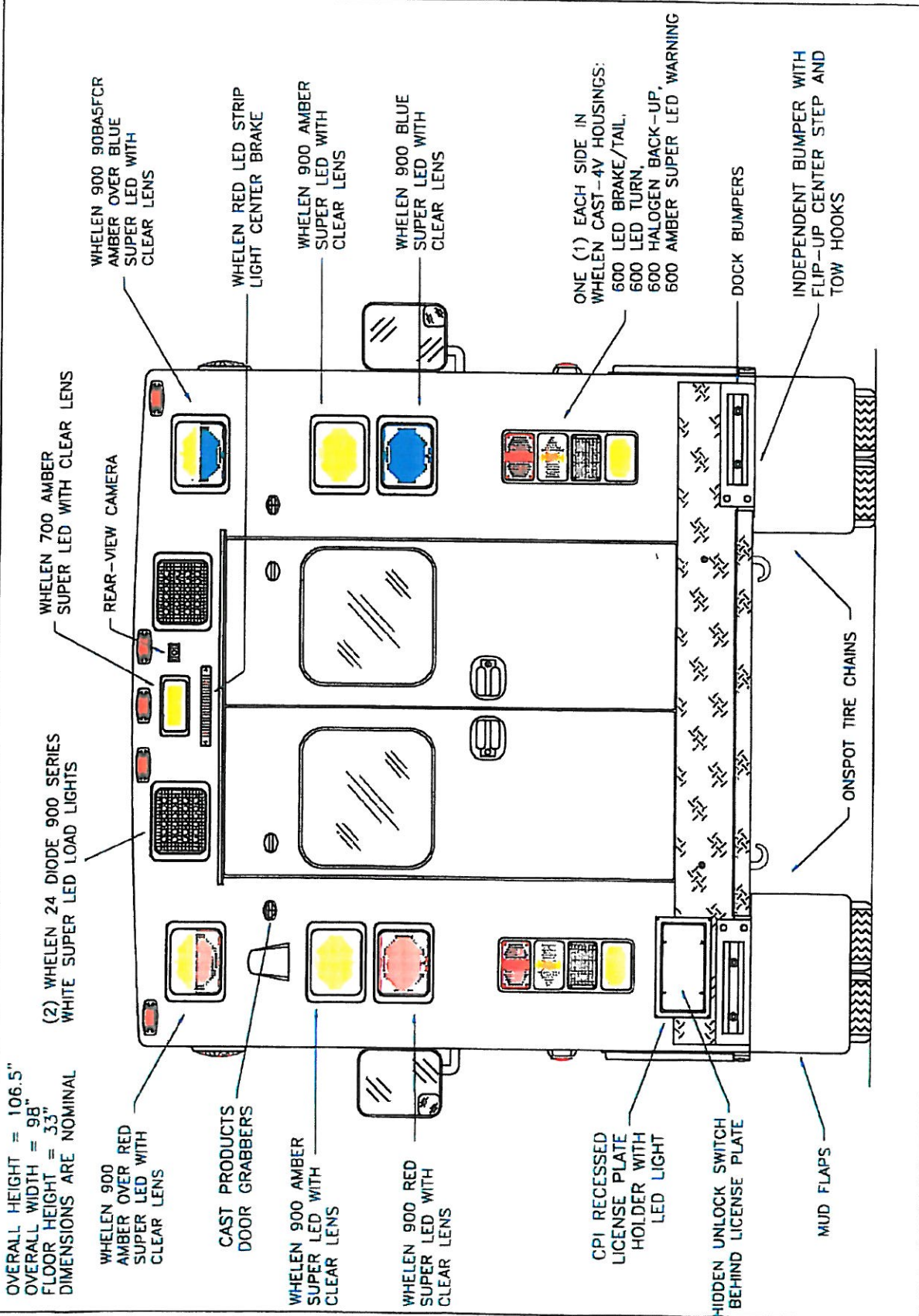

LITTLETON, COLORADO

2009 REAR EXTERIOR VIEW
 FORD E-450 CHASSIS

DATE: 02 FEB 09		DRAWING NO.	
DRG.	REV.	GLF	B
			LITTLETON-11

OVERALL HEIGHT = 106.5"
 OVERALL LENGTH = 268.5"
 MODULE LENGTH = 169"

KUSSMAUL 20 AMP
 SUPER AUTO-EJECT
 SHORELINE INLET

WHELEN 700 RED/AMBER
 SUPER LED WITH
 CLEAR LENS
 IN 15" CPI HOUSING

WHELEN 900 RED-OVER-AMBER SUPER LED WARNING LIGHTS
 WITH CLEAR LENSES

WHELEN 900 SERIES 24-DIODE LED SCENE LIGHTS

12VDC OUTLET

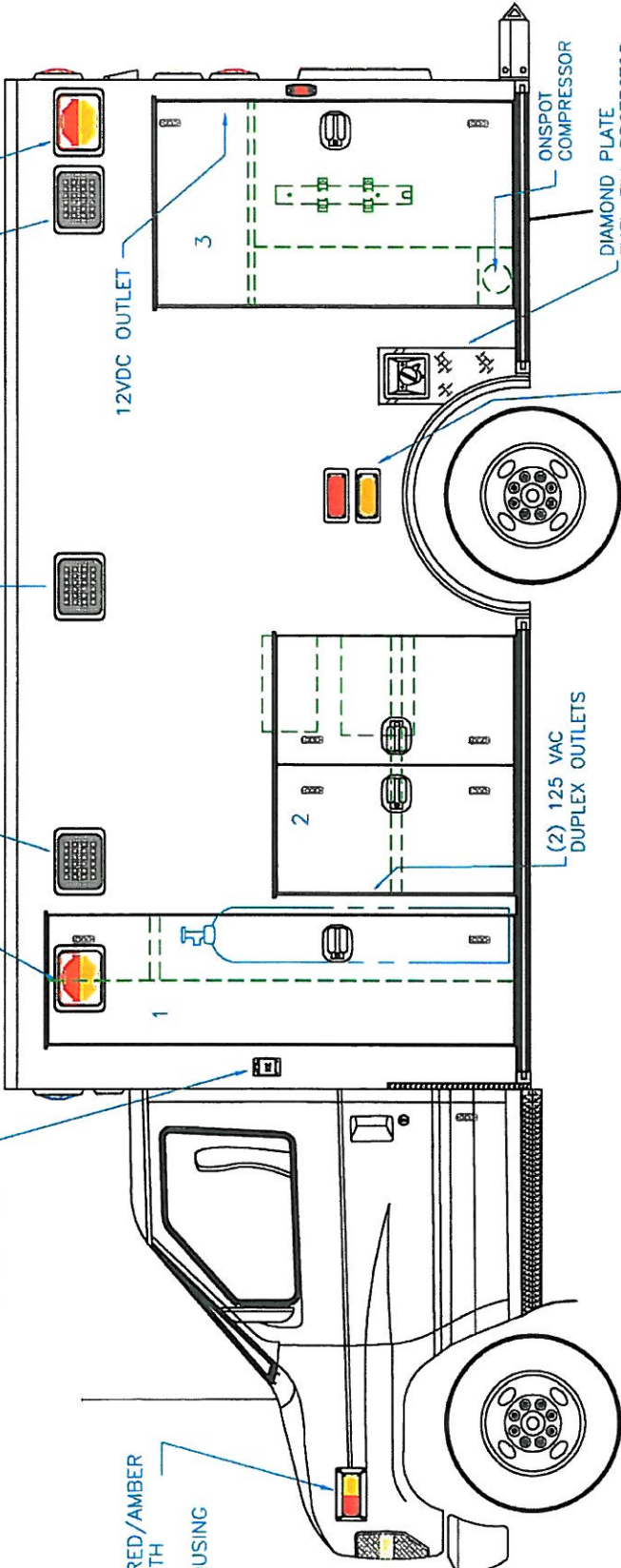

COMPARTMENT

O.S.S. #1
 CLEAR OPENING: 76.75h x 18.25w
 INSIDE DIM'S.: 77.75h x 24.25w x 20.75d
 OXYGEN STORAGE REARWARD OF VERTICAL DIVIDER
 (1) ADJUSTABLE SHELF ABOVE OXYGEN

O.S.S. #2
 CLEAR OPENING: 38.50h x 39.75w
 INSIDE DIM'S.: 41.75h x 44.00w x 20.00d
 (1) ADJUSTABLE SHELF IN COMPARTMENT WITH
 NOTCH-OUT AREA FOR SUCTION RECESS

O.S.S. #3
 CLEAR OPENING: 58.50h x 30.75w
 INSIDE DIM'S.: 60.25h x 34.75w x 20.00d
 FIXED SHELF WITH 1" LIP, BOTTOM OF SHELF 42" FROM FLOOR OF COMPARTMENT
 VERTICAL DIVIDER BELOW FIXED SHELF, 10" FROM FORWARD WALL
 CUSTOMER SUPPLIED SCBA BRACKET MOUNTED ON INSIDE OF DOOR

CUSTOMER SUPPLIED, BRAUN INSTALLED EQUIPMENT-LOCATIONS TBD:
 HALIGAN TOOL, AXE, FIRE EXTINGUISHER, 12 VOLT STREAMLIGHTS,
 STORAGE FOR SAGER TRACTION DEVICE, KED EXTRICATION DEVICE

⊞ = (2) WHELEN TIR3 AMBER LED LIGHTS ON INSIDE OF EACH MODULE STORAGE
 COMPARTMENT DOOR AND (1) ON INSIDE OF CAB DOOR. (9 THIS SIDE)

LED COMPARTMENT LIGHTING

COMPARTMENT FLOORS AND SHELVES TO HAVE RED TURTLE TILE

DIMENSIONS ARE NOMINAL

LITTLETON, COLORADO

2009 STREETSIDE EXTERIOR VIEW
 FORD E-450 CHASSIS

DRAWING NO.

DATE: 23 FEB 09
 DWG. REV. D

1:28

GLF

LITTLETON-12

OVERALL HEIGHT = 106.5"
 OVERALL LENGTH = 268.5"
 MODULE LENGTH = 169"

WHELEN 900 RED-OVER-AMBER SUPER LED WARNING LIGHTS WITH CLEAR LENSES

WHELEN 900 SERIES 24-DIODE LED SCENE LIGHTS

12VDC OUTLET

SCBA BRACKET ON INSIDE OF DOOR

WHELEN 700 RED SUPER LED OVER 700 AMBER SUPER LED. BOTH WITH CLEAR LENSES

AIR HORN COMPRESSOR

BATTERY COMPARTMENT (3) BATTERIES ON SLIDE-OUT TRAY

STAINLESS STEEL ASSIST HANDLE ON DOOR POST

5

4

SLIDING DOOR

WHELEN 700 RED/AMBER SUPER LED WITH CLEAR LENS IN 15" CPI HOUSING

COMPARTMENT O.S.S #4 WITH 1/3 - 2/3 DOUBLE DOORS CLEAR OPENING: 76.75h x 31.50w INSIDE DIM'S: 77.75h x 36.00w x 20.00d VERTICAL DIVIDER 12" FROM LEFT WALL OF COMPARTMENT FIXED SHELF WITH 1" LIP, ON LEFT SIDE OF DIVIDER, STAIR CHAIR STORAGE ABOVE SHELF; AUTOPULSE STORAGE BELOW SHELF. SHELF TO BE LOCATED 40" FROM COMPARTMENT CEILING.

(3) ADJUSTABLE SHELVES WITH 1" LIPS ON RIGHT SIDE OF DIVIDER. LOWER SHELF TO BE 36" FROM COMPARTMENT CEILING

O.S.S #5 CLEAR OPENING: 46.75h x 17.25w INSIDE DIM'S. 5: SEE PARTITION INTERIOR VIEW INSIDE/OUTSIDE STORAGE WITH THREE (3) ADJUSTABLE SHELVES SHELF EDGES TOWARDS EXTERIOR COMPARTMENT OPENING DO NOT HAVE LIPS

⊞ = (2) WHELEN TIR3 AMBER LED LIGHTS ON INSIDE OF EACH MODULE STORAGE COMPARTMENT DOOR AND (1) ON INSIDE OF CAB DOOR. (7) THIS SIDE LED COMPARTMENT LIGHTING

COMPARTMENT FLOORS AND SHELVES TO HAVE RED TURTLE TILE

DIMENSIONS ARE NOMINAL

LITTLETON, COLORADO

2009 CURBSIDE EXTERIOR VIEW
 FORD E-450 CHASSIS

DATE: 14 FEB 09
 DWG: GLF
 REV: C

1:28

LITTLETON-13

COMPARTMENTS: #1/#2, AND #3/#4 HAVE LIFT-UP RESTOCKING FRAMES. # 6 HAS DROP-DOWN RESTOCKING FRAME

12VDC OUTLET WITHIN COMPARTMENT

(2) OHIO MED OXYGEN OUTLETS, CENTERED ABOVE COUNTERTOP

THREE (3) FLUORESCENT LIGHTS

1/25 VAC OUTLET
RADIO FADER

WELDON VISTA III CONTROL SCREEN

OXYGEN ACCESS, BYPASS VALVE

EXHAUST VENT

26" FOR LIFEPAK
18.00

18.25

48.00

STAINLESS STEEL
COVERED FLOOR

EVS 1780 SEAT WITH 5-POINT HARNESS MOUNTED ON 188S BASE. NOTE: INTENT IS NOT TO SWIVEL BASE, BUT TO HAVE HARNESS ATTACHED TO SEAT WHEN USING SEAT SLIDES. MOUNT AS CLOSE TO WALL AS POSSIBLE.

LOCKING DRAWER W/WRITING SURFACE

EVS SEAT WITH ADULT 5-POINT HARNESS AND INTEGRAL CHILD SAFETY SEAT, MOUNTED ON SWIVEL BASE

COMPARTMENT

#1/#2 DOOR OPENING: 11.75h x 43.75w
INSIDE DIMS: 14.25h x 45.75w x 17.25d
PERMANENT DIVIDER(CENTERED)
ONE (1) ADJUSTABLE SHELF EACH SIDE

#3 DOOR OPENING: 6.75h x 29.25w
INSIDE DIMS: 9.25h x 31.25w x 17.25d

#4 DOOR OPENING: 15.50h x 14.25w
INSIDE DIMS: 18.00h x 16.25w x 17.25d
ONE (1) ADJUSTABLE SHELF

#6 DOOR OPENING: 15.00h x 19.50w
INSIDE DIMS: 17.00h x 21.25w x 16.25d
ONE (1) ADJUSTABLE SHELF

#7 CABINET IN WALK-THRU AREA
MODULE SIDE TO HAVE ADJUSTABLE SHELF
CAB SIDE TO HAVE ANGLED DIVIDERS FOR BINDERS
(SEE FRONT WALL VIEW FOR DIMENSIONS)

#8 PULL-OUT DRAWER
INSIDE DIMS: 5.00h x 14.50w x 13.25d

#9 RECESSED IMPACT 324 ASPIRATOR SYSTEM
RIGHT-HINGED ACRYLIC DOOR WITH FLUSH-PULL LATCH
3" HOLE IN DOOR TO ROUTE SUCTION TUBING THROUGH

DIMENSIONS ARE NOMINAL

LITTLETON, COLORADO	2009 STREETSIDE INTERIOR VIEW		DRAWING NO.
	DATE: 23 FEB 09	REV. GLF D	LITTLETON-14
	1:22		

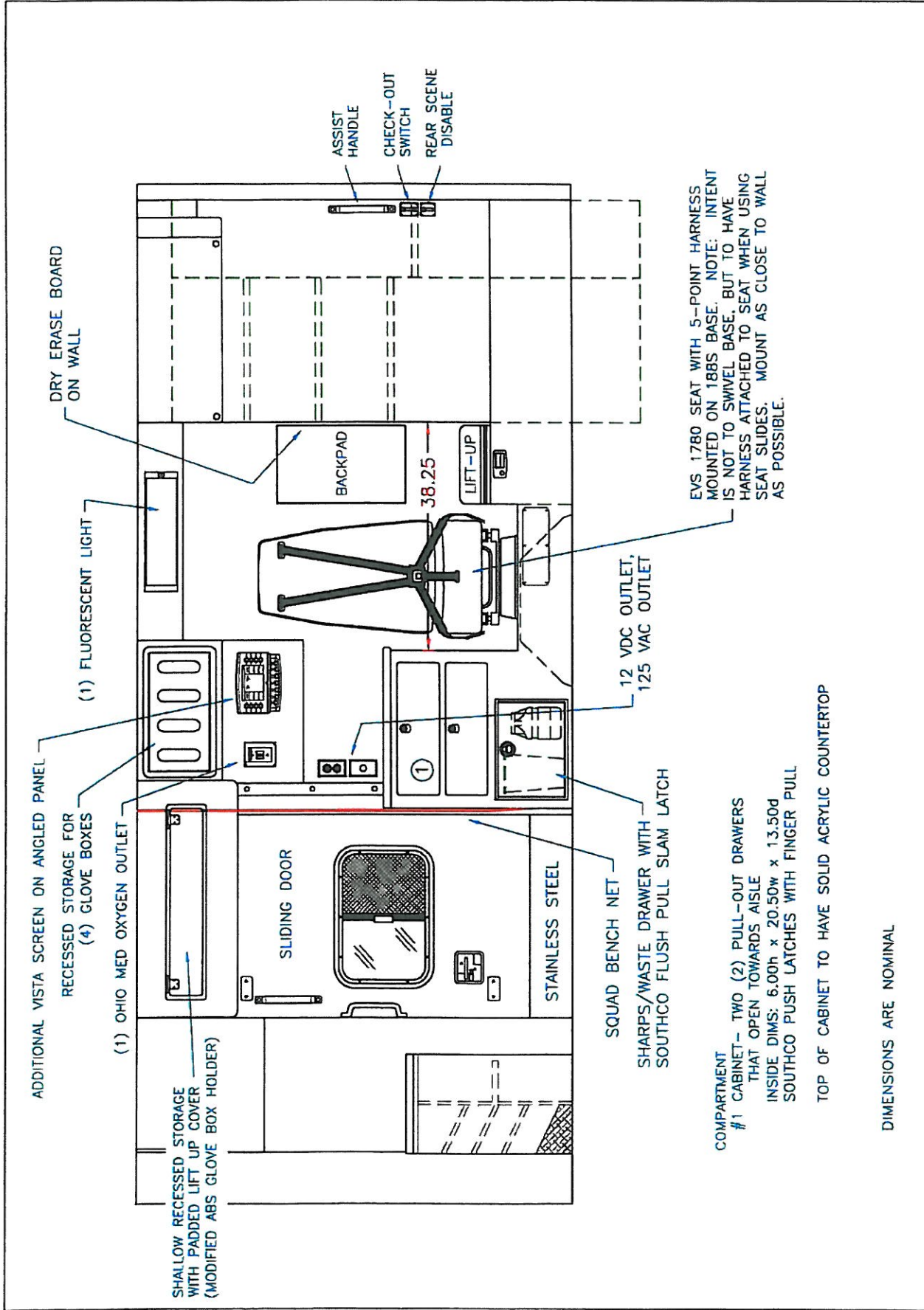

LITTLETON, COLORADO	2009 CURBSIDE INTERIOR VIEW			DRAWING NO. LITTLETON-15	
	DATE: 14 FEB 09	DWG. REV. D	1:20	GLF	D

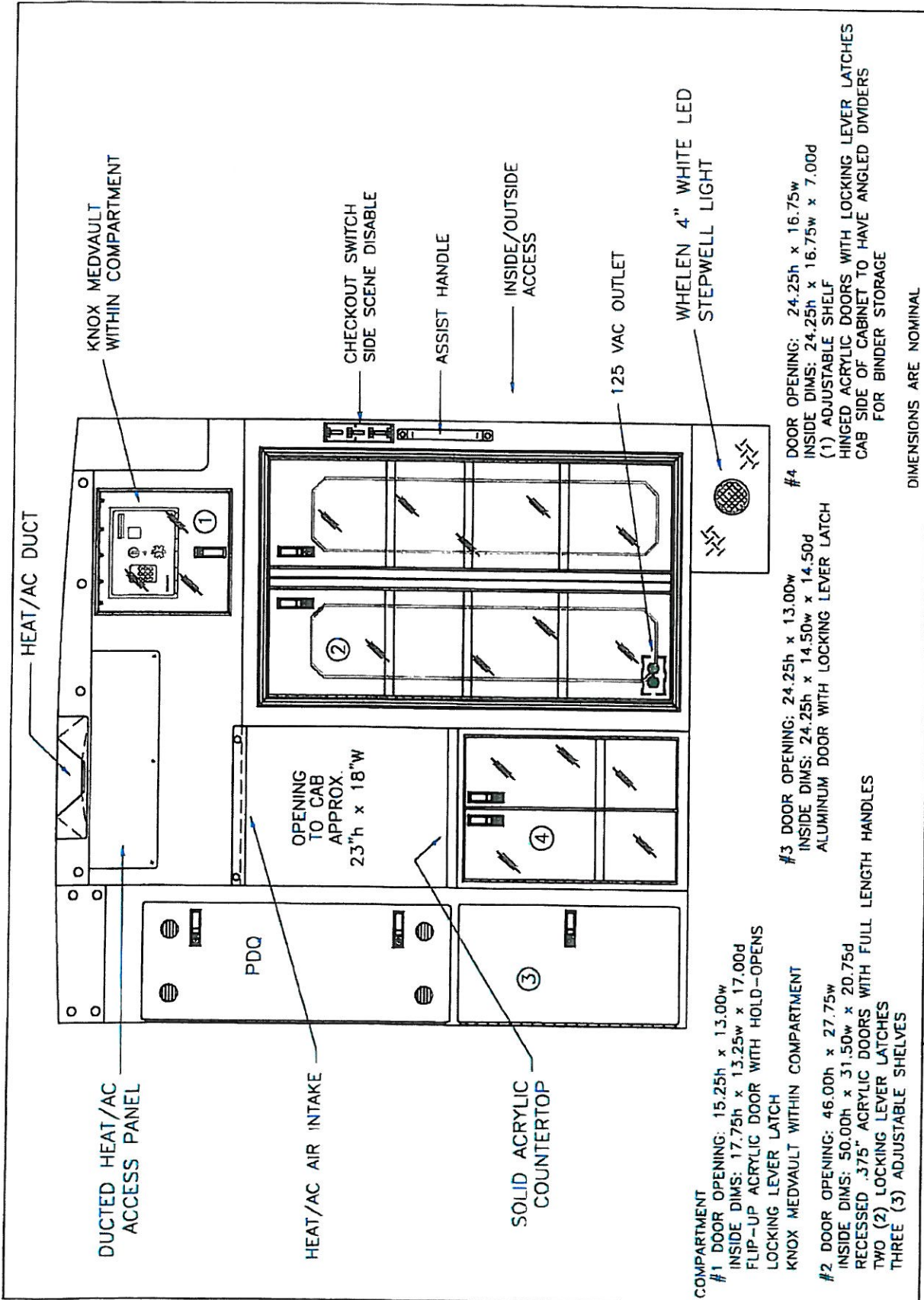

COMPARTMENT

#1 DOOR OPENING: 15.25h x 13.00w
 INSIDE DIMS: 17.75h x 13.25w x 17.00d
 FLIP-UP ACRYLIC DOOR WITH HOLD-OPENS
 LOCKING LEVER LATCH
 KNOX MEDVAULT WITHIN COMPARTMENT

#2 DOOR OPENING: 46.00h x 27.75w
 INSIDE DIMS: 50.00h x 31.50w x 20.75d
 RECESSED .375" ACRYLIC DOORS WITH FULL LENGTH HANDLES
 TWO (2) LOCKING LEVER LATCHES
 THREE (3) ADJUSTABLE SHELVES

#3 DOOR OPENING: 24.25h x 13.00w
 INSIDE DIMS: 24.25h x 14.50w x 14.50d
 ALUMINUM DOOR WITH LOCKING LEVER LATCH

#4 DOOR OPENING: 24.25h x 16.75w
 INSIDE DIMS: 24.25h x 16.75w x 7.00d
 (1) ADJUSTABLE SHELF
 HINGED ACRYLIC DOORS WITH LOCKING LEVER LATCHES
 CAB SIDE OF CABINET TO HAVE ANGLED DIVIDERS
 FOR BINDER STORAGE

DIMENSIONS ARE NOMINAL

LITTLETON, COLORADO	2009 PARTITION INTERIOR VIEW		DRAWING NO. LITTLETON-16
	DATE: 03 FEB 09	REV: C	
	DWG: GLF	REV: C	

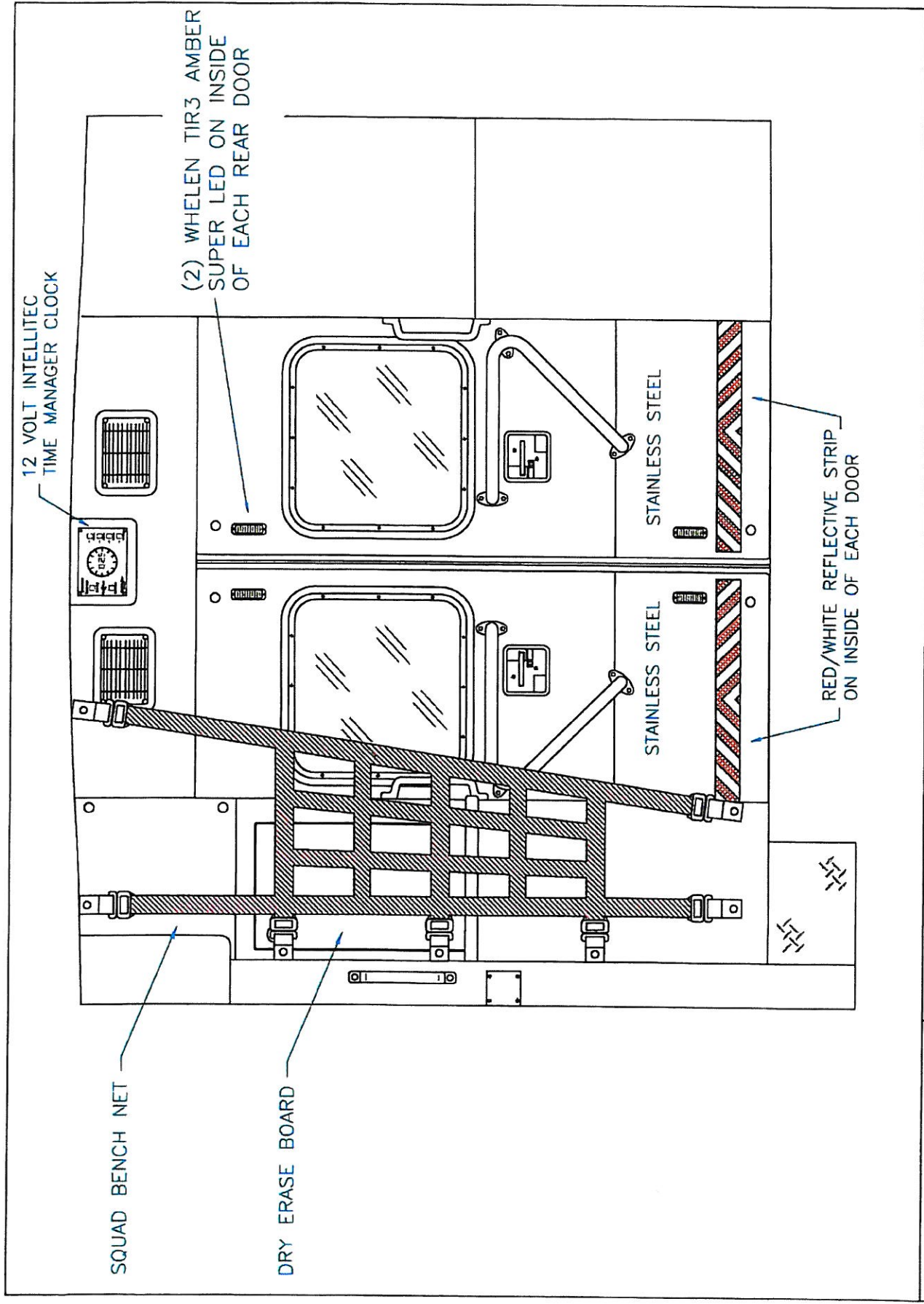

LITTLETON, COLORADO	2009 REAR INTERIOR VIEW		DRAWING NO. LITTLETON-17	
	DATE: 16 FEB 09	REV. GLF B	1:12	

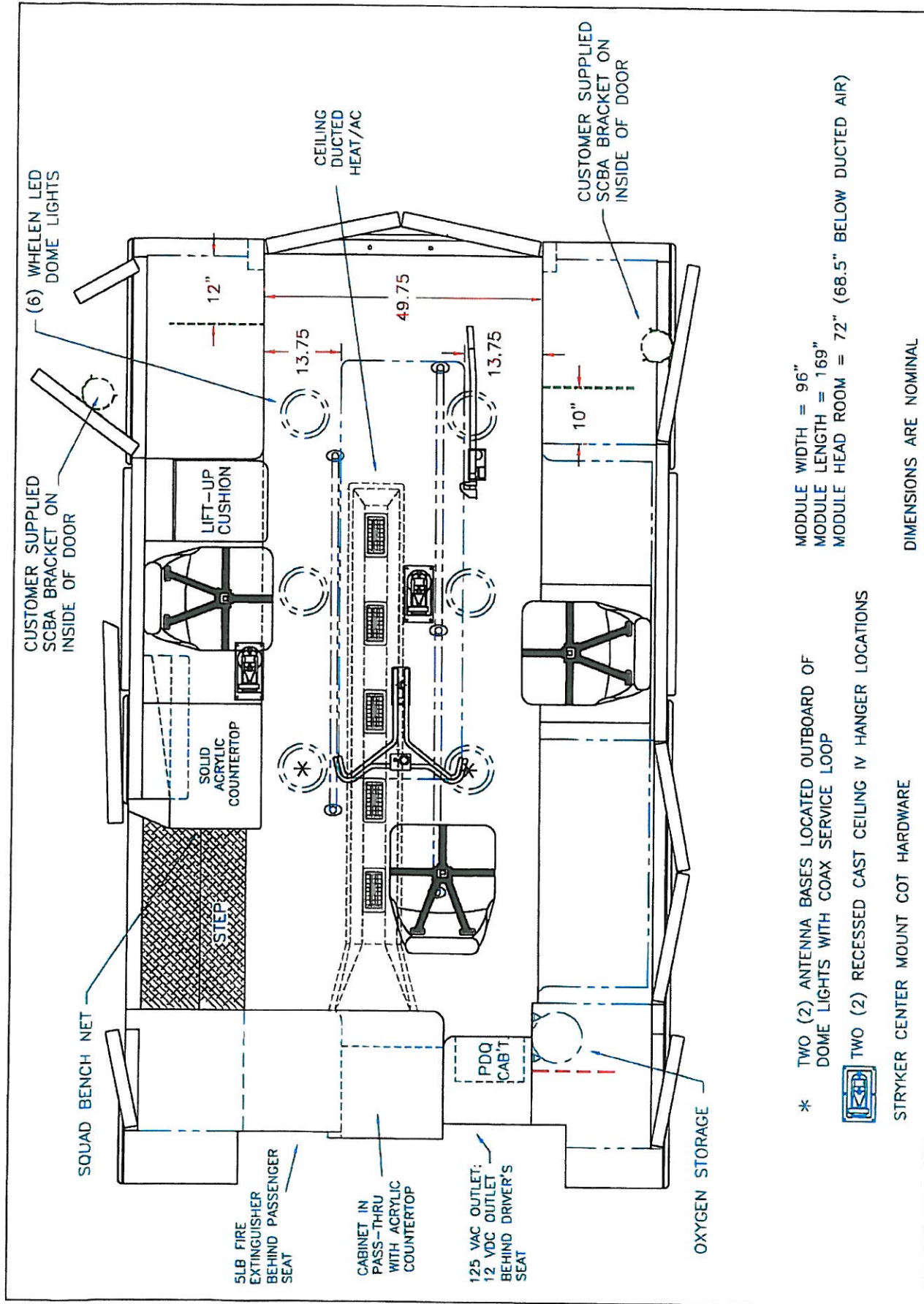

MODULE WIDTH = 96"
 MODULE LENGTH = 169"
 MODULE HEAD ROOM = 72" (68.5" BELOW DUCTED AIR)

* TWO (2) ANTENNA BASES LOCATED OUTBOARD OF DOME LIGHTS WITH COAX SERVICE LOOP
 TWO (2) RECESSED CAST CEILING IV HANGER LOCATIONS

STRYKER CENTER MOUNT COT HARDWARE
 DIMENSIONS ARE NOMINAL

LITTLETON, COLORADO	2009 FLOOR INTERIOR VIEW		DATE: 14 FEB 09	DRAWING NO. LITTLETON-18
	1:22	GLF	REV. C	